

# HOTEL COZI

## WETLAND

悦品天秀酒店·元朗



### ENJOY A WARM AND COZI WELCOME

At Hotel COZI • Wetland we believe your time is precious. Whether you're soaking up the natural wonders around the hotel, enjoying a snack or a meal, keeping up your fitness routine in our gym, or simply relaxing in the homely comfort of your elegantly appointed room, we want you make the most of every moment of your stay.

We are 5-minute drive from MTR Tin Shui Wai Station, within easy reach of all the major sights and attractions in Hong Kong. Regular shuttle buses run between our hotel and MTR Tin Shui Wai Station, nearby shopping malls, Hong Kong Disneyland, Ngong Ping 360 and the airport.

### COZI COMFORTS

At Hotel COZI we want you to enjoy your stay in total comfort.

#### COZI Floor

- COZI Deluxe
- COZI Premier
- COZI Family

#### Elite Floor

- Elite Deluxe
- Elite Greenery
- Elite Premier
- Elite Family

### COZI DELIGHTS

Our facilities are designed with your comfort in mind.

- The Platter
- Grazi Garden
- Fitness Centre



Indulge in  
COZI Comfort

悦享舒適  
品味悠閒

### YOUR COMFORT IS ASSURED

- Complimentary Wi-Fi internet access
- Flat TV with cable channels
- Complimentary use of smartphone
- IDD telephone with voice mail system
- Complimentary coffee and tea making facilities
- Mini bar
- In-room safe
- Electric kettle
- Hair dryer
- Bathroom amenities
- Slippers
- Alarm clock (available on Elite Floor)
- Extra bed
- Microwave oven (available on Elite Floor)
- Iron and ironing board (upon request)
- Newspaper (upon request)
- Travel adaptor (upon request)
- Baby crib (upon request)

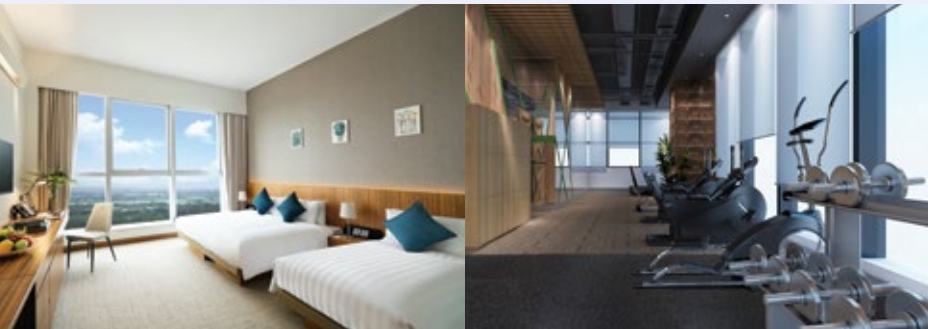

Photos are for reference only 圖片只供參考

### 愉悦心境 品味生活

從悦品天秀酒店·元朗出發，享受旅程的每一個難忘時刻。

無論是到毗鄰的生態公園擁抱大自然，在酒店餐廳品嚐各式美食，或是到健身中心保持鍛鍊，在舒適的客房內簡單地放鬆自己，我們都竭誠為您提供愉悅舒適的體驗。

悦品天秀酒店·元朗距離港鐵天水圍站僅5分鐘車程，您亦可以選乘各種交通工具前往香港各個名勝景點。酒店同時提供穿梭巴士前往港鐵天水圍站、鄰近的大型購物商場、香港迪士尼樂園、昂坪360及機場。

### 悦品酒店 您的愜意居所

在悦品天秀酒店·元朗，每一刻您都將倍感舒適。

#### 悦品之選

- 豪華悦品客房
- 尊貴悦品客房
- 家庭悦品客房

#### 優悦之選

- 豪華優悦客房
- 茵翠優悦客房
- 尊貴優悦客房
- 家庭優悦客房

### 盡享便利設施

我們努力完善每個細節，務求讓您時刻感受到輕鬆、便利。

- The Platter
- 綠庭園
- 健身中心

### 舒適每一天

- 免費無線上網服務
- 平面電視以及有線電視頻道
- 免費使用智能手機
- 國際長途電話及留言服務
- 免費咖啡及茶沖調設備
- 迷你吧
- 房內保險箱
- 電熱水壺
- 吹風機
- 浴室用品
- 拖鞋
- 鬧鐘 (只適用於優悦之選)
- 額外加床
- 微波爐 (只適用於優悦之選)
- 燙斗及燙衣板 (按客人要求)
- 報紙 (按客人要求)
- 旅遊轉接頭 (按客人要求)
- 嬰兒床 (按客人要求)

## SERVICE WITH A SMILE

Our services are graciously offered and tailored to suit your personal needs.

- Non-smoking rooms
- Wheel chair and barrier-free rooms
- 24-hour reception
- Express check-in and check-out
- Concierge and local tours arrangement
- Luggage storage
- Postal service
- Copy and fax service
- Shuttle bus service
- Limousine service
- Car park
- Currency exchange service
- On-call medical service (upon request)
- Babysitting (upon request)
- Wake-up call service
- Laundry, dry cleaning and pressing service

## REACH US EASILY

- Hong Kong International Airport [35-minute drive]
- MTR Light Rail Tin Sau Station [2-minute walk]
- MTR Tin Shui Wai Station Exit E1 [5-minute by MTR]

## ENJOY YOUR COZI STAY WITH US!

Make the most of your visit to Hong Kong, and stay with us! Enjoy our service, take advantage of our special location, embrace all our COZI comforts and have a wonderful time. You'll be truly welcome.

## 貼心為您服務

我們用誠摯有禮的服務，貼心照顧您的每項需求。

- 非吸煙客房
- 輪椅及無障礙客房
- 24小時接待處
- 特快入住及退房服務
- 禮賓服務及本地旅遊安排
- 行李寄存服務
- 郵遞服務
- 傳真及影印服務
- 穿梭巴士
- 豪華客車租賃服務
- 停車場
- 外幣兌換服務
- 電召醫療服務 (按客人要求)
- 托兒服務 (按客人要求)
- 喚醒服務
- 洗衣、乾洗及燙衣服務

## 輕鬆抵達悦品天秀酒店·元朗

- 香港國際機場 [約35分鐘車程]
- 輕鐵天秀站 [步行約2分鐘]
- 港鐵天水圍站E1出口 [乘坐港鐵約5分鐘]

## 選擇悦品 選擇愉悅之旅

入住悦品天秀酒店·元朗，享受我們無比貼心的服務，並體驗獨特地理位置帶來的便利，展開精彩寫意的香港之旅。

## HONG KONG IS HOME TO MANY FAMOUS SPOTS

### Attractions

- Hong Kong Wetland Park [5-minute walk]
- Nam Sang Wai [10-minute drive]
- Mai Po Nature Reserve [25-minute drive]
- Tai Tong Organic EcoPark [15-minute drive]
- Ocean Park [60-minute by MTR]
- Hong Kong Disneyland [25-minute drive]
- Ngong Ping 360 [30-minute drive]

### Shopping Malls & Areas

- One Sky Mall [1-minute walk]
- T Town [5-minute by MTR]
- YOHO Mall [15-minute by MTR]
- tmtplaza [15-minute by MTR]
- V city [15-minute by MTR]
- Citygate Outlets [60-minute by MTR]
- Mongkok Shopping Area [30-minute by MTR]
- Tsimshatsui Shopping Area [35-minute by MTR]
- Causeway Bay Shopping Area [50-minute by MTR]

## 精彩的香港之旅

### 名勝

- 香港濕地公園 [步行約5分鐘]
- 南生圍 [約10分鐘車程]
- 米埔自然保護區 [約25分鐘車程]
- 大棠有機生態園 [約15分鐘車程]
- 海洋公園 [乘坐港鐵約60分鐘]
- 香港迪士尼樂園 [約25分鐘車程]
- 昂坪360 [約30分鐘車程]

### 購物熱點

- 天一商城 [步行約1分鐘]
- T Town [乘坐港鐵約5分鐘]
- 形點 [乘坐港鐵約15分鐘]
- 屯門市廣場 [乘坐港鐵約15分鐘]
- V city [乘坐港鐵約15分鐘]
- 東薈城名店倉 [乘坐港鐵約60分鐘]
- 旺角購物區 [乘坐港鐵約30分鐘]
- 尖沙咀購物區 [乘坐港鐵約35分鐘]
- 銅鑼灣購物區 [乘坐港鐵約50分鐘]



Wetland Park Road 濕地公園路



8 Tin Sau Road, Tin Shui Wai,  
Yuen Long, Hong Kong  
香港元朗天水圍天秀路8號

T 電話 +852 3583 6288

E 電郵 info.wetland@hotelcozi.com

W 網址 www.hotelcozi.com/wetland

Hotel COZI · Wetland 悦品天秀酒店·元朗



Managed by

**TANG'S**  
LIVING GROUP